



GADOSO REVOLUTION 1

GETTING STARTED GUIDE

1 DOWNLOAD AND INSTALL SOFTWARE

Go to www.wanhao3dprinter.com --- Download software --- **GR1 to download software**. Install the software by entering the license. The license is stick on the user manual or on the printer. Notice, should you have any question about the license. Email us at support@wanhao3dprinter.com

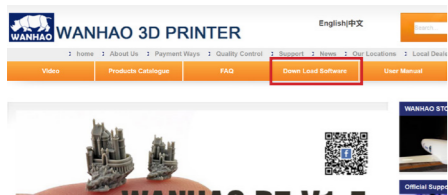



GR1WorkShop+Setup+2.0.6.exe

2 UNPACK AND CONNECT CABLES

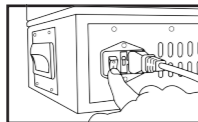
Connect the power supply to printer and turn on the switch behind the printer. Open the cover and software and load the object (LSTL/STL/OBJ).



Click  to import the 3D file(STL, OBJ), You can add support, change direction etc.

Then Click  to slice the object into GR1 file. Copy the file into the flash disk.

3 Click on  and you can see the sliced layers that are going to be printed on your GR1. You can see the layers by sliding the slider up and down on the right side of the screen.

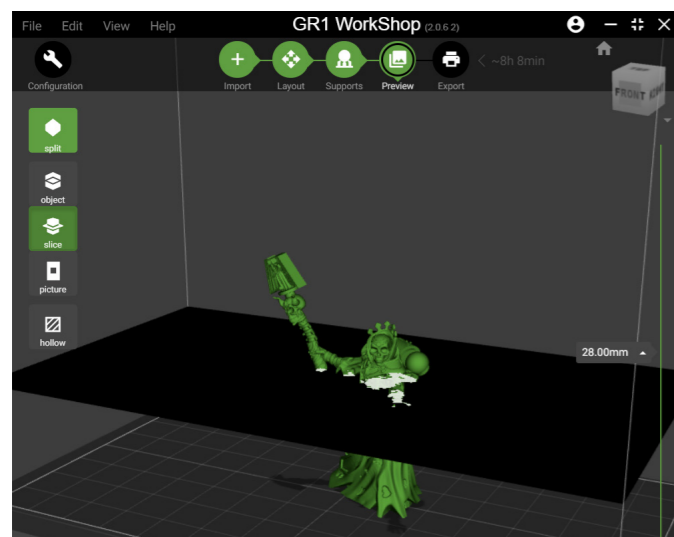

4 SLICER CONFIGURATION

For different object you may want different resolution and speed. Go to configuration to change the setting of speed, thickness, curing time....

NOTE: For more information about setting, Download User Manual from Wanhao3dprinter.com.

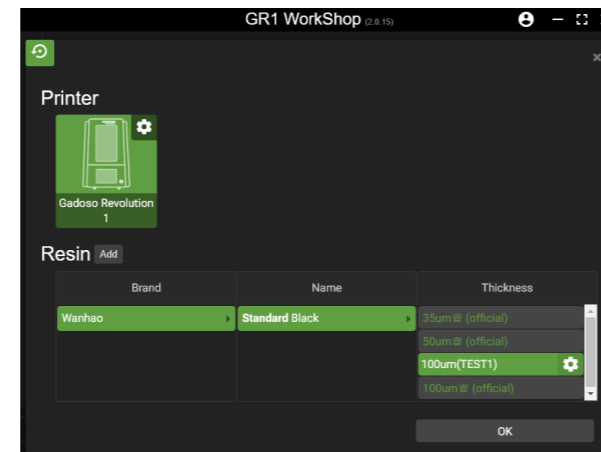

5 Click on  than .GR1 and save the model as .GR1 file. Software start to render and generate the printing file. Copy this file into Flash disk.

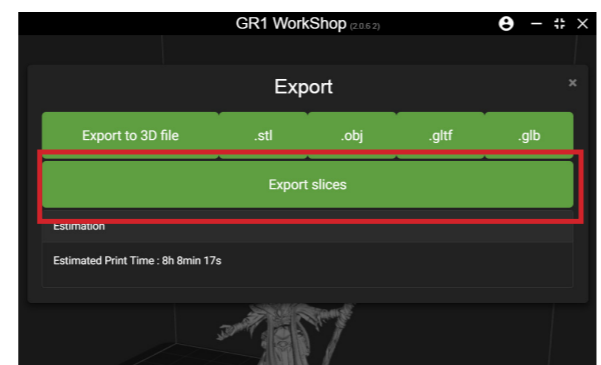

6 PREPAIR GR1 FOR PRINTING

Open the packing. Put the printer onto one flat table. Pull open the front cover and take out **tool box**. The building plate is inside the **tool box**. Loose the 2 VAT locking screw to take out the VAT and **protection Foam**.

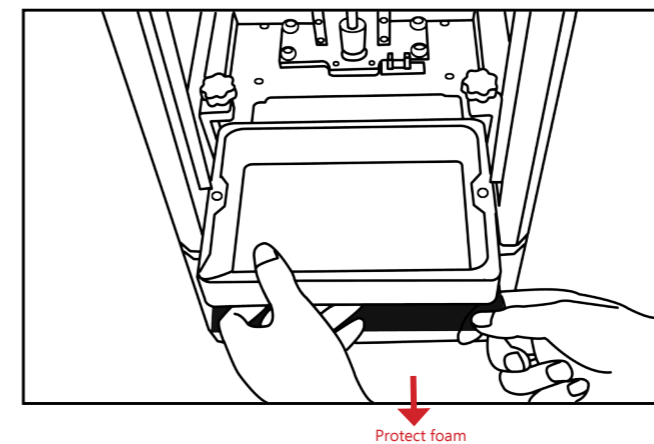
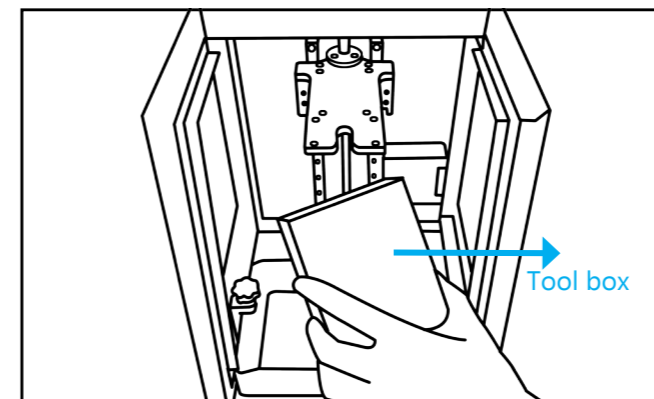

8 Install the VAT onto the printer. Make sure the 2 locking screw well secure the VAT from moving up and down. **NOTE:** VAT window side toward you.

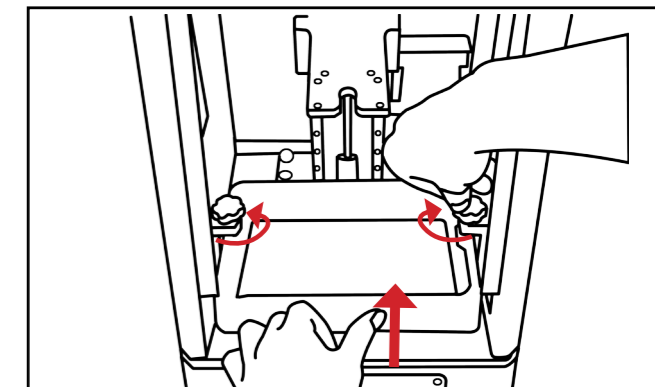

9 Loose the knob on the building plate. Insert the building plate into the holder slot. Tighten the knob to secure the building plate. Note: The printer has been calibrated before dispatching. In case you are not satisfied with the current calibration. Please read Re-calibration on User Manual.)

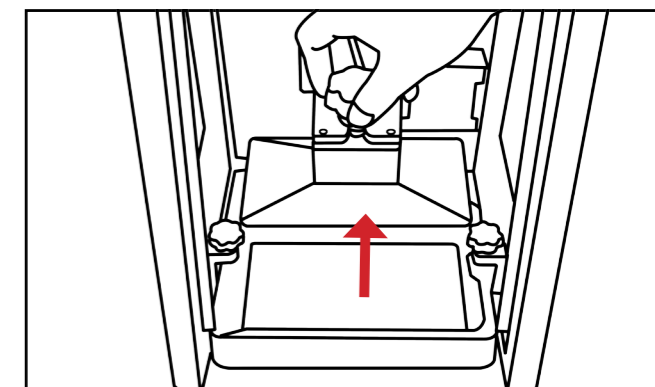

7 FUNCTION CHECKING.

Click the **Tool -- Detection --**  on the touching screen. The WANHAO logo shall project on the printing display.

Click the **Tool -- Move to Z -- Home**. The Z axis module would move down to 0 position.

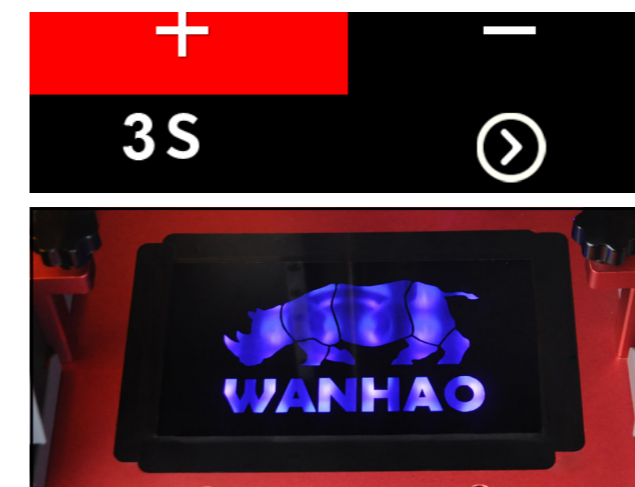

10 Raise the building plate and pour the resin inside until the resin level reach the Min scale.

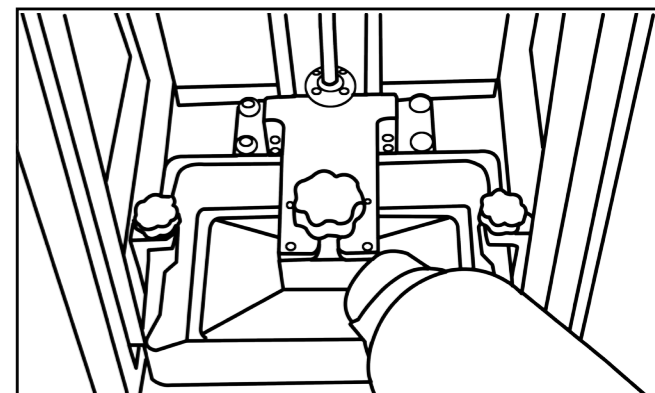

- 11 Hang on the front cover. Insert the Flash disk. Go to **Print**—**Choose the file** — **Print**.



Note: loading file may take few seconds, please print when you see the Preview displayed.

12 **POST PROCESSING**

Place the platform to WANHAO Washer. Remove the objects by sliding the scraper in at their base. Wash off any liquid polymer in alcohol container. You can gently clean it with a soft brush or sponge, take care not to damage it, it will not achieve full hardness until after post exposing in UV light. A WANHAO WASHER will clean your objects without the possibility of damaging them.

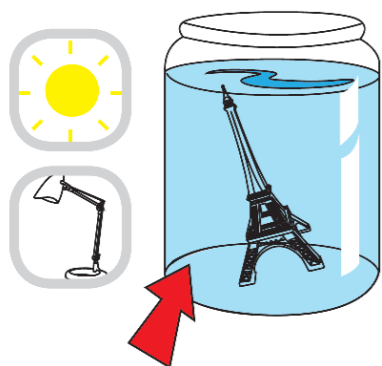

Alcohol

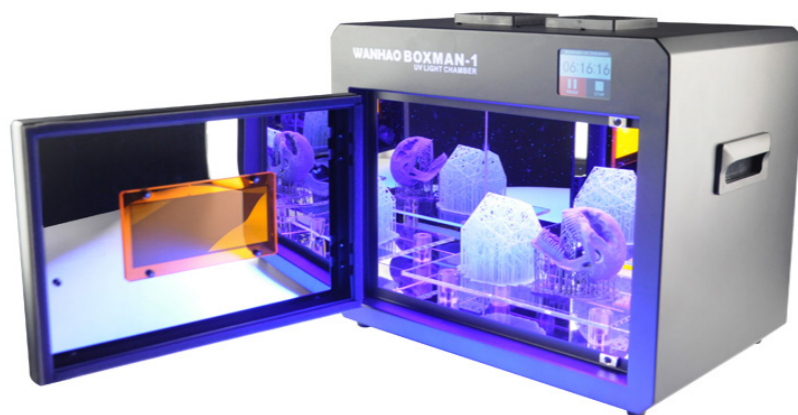

Check your object is thoroughly clean as resin cannot be easily removed afterwards and then leave it under water in sunlight for about 3 days. Or in the **WANHAO CURING BOX** for 20 minutes. The longer you leave it under water the darker the colour will get, some colour change is inevitable. When it is completely post-exposed it will be strong and have a dry surface. Empty the contents of the vat back into the bottle by pouring through a sieve with the vat on a flat surface wipe the inside thoroughly with absorbent paper. Replace the film when damaged.



ZHEJIANG WEIBIN 3D TECHNOLOGY CO.,LTD
No. 18 Zhen Shan Road, Chang Kou Town,
Fuyang District, Hangzhou City, Zhejiang
Province, China

support@wanhao3dprinter.com
www.wanhao3dprinter.com

GADOSO REVOLUTION 1

GETTING STARTED GUIDE

